

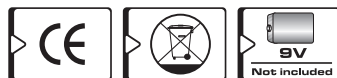

389 Multiscanner Stud Finder

ELECTRONIC LIVE WIRE, METAL & STUD SENSOR

User Manual



EN

Thank you for purchasing the Kapro 389 Multiscanner Stud Finder.

This electronic live wire, metal & stud sensor has been designed for the following applications:

- Finding hidden live AC wires, metal, studs & wood through drywall and other common wall materials
- Preventing electrocution caused by drilling through live wires

Features:

- Electronic sensors
- Traces live wires
- Easy to read backlit screen marks exact position
- Differentiates between wood, metal and live wires
- Detection buzzer
- Automatic scan

NOTE

Keep this user manual in a safe place for future reference.

Read this user manual thoroughly before using your stud finder. Always operate the stud finder according to the procedures and warnings in this manual.

Battery Installation

1. Remove the battery compartment cover at the back of the unit.
2. Insert a 9 V battery and replace cover.

SCANNING IN STUD MODE

Use Stud mode for depths of up to 1 1/2" (38mm).

1. Position the sensor flat against the wall. Select "STUD" Mode. Press and hold ON / OFF button.
2. Slowly slide the unit horizontally across the wall, to the left or right. Keep the unit base in contact with the wall. When full bars appear on the LCD and a steady tone is emitted, you have located the edge of the stud. Mark this spot.
3. Continue holding the ON / OFF button and scan beyond the marked spot until the bars

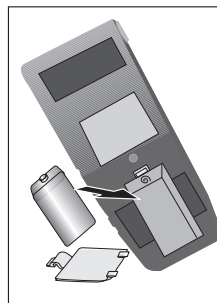

2

disappear, and then slide in reverse direction to locate the other edge of the stud. Mark this spot. The stud position is between these two marks.

4. To confirm the stud position, turn off the unit and place on the wall as close as possible to the presumed position of the stud. Press and hold ON / OFF button and repeat the process.

CAUTION

Depending on the proximity of electrical wiring or pipes to the wall surface, the sensor may detect them in the same manner as studs. Caution should always be used when nailing, cutting or drilling in walls, floors and ceilings that may contain these items.

To avoid surprises, remember that studs or joists are normally spaced 16 in. (406mm) or 24 in. (610mm) apart and are 1 1/2 in. (38mm) in width. Anything closer together or different in width may not be a stud, joist or firebreak. Always turn off the power when working near electrical wires.

3

SCANNING IN METAL MODE

Metal pipes can be detected at a depth of up to 1 1/2 in. (38mm)

Copper pipes can be detected at a depth of up to 1 1/4 in. (30mm)

Other metal objects can be detected at a depth of up to 2 in. (50mm)

1. Select "METAL" mode.
2. Press and hold ON / OFF button. Calibrate the unit away from metal objects. Position the unit flat against the wall.
3. Continue holding the ON / OFF button and slowly slide the unit horizontally across the wall, to the left or right. Keep the unit base in contact with the wall. The center bar on the LCD screen indicates closest proximity to metal. When the center bar appears, mark this spot.
4. Continue holding the ON / OFF button and scan beyond the marked spot until the bars disappear, and then slide in reverse direction to locate the other edge of the metal object. Mark this spot. The position of the metal object is located between these two marks.
5. To confirm the metal position, turn off the unit and place on the wall as close as possible to the presumed position of the metal object. Press and hold ON / OFF button and repeat the process.

4

SCANNING IN AC MODE

Continuous AC voltage detection: The unit detects from 90 to 250 V at 50 to 60 Hz AC in a HOT unshielded electrical wire that is at a depth of up to 2 in. (50mm) of the wall surface. The voltage detection feature works continuously in all modes for safety.

1. Select AC mode.
2. Press and hold ON/OFF button. Calibrate the unit away from any hot wiring. Position the unit flat against the wall.
3. Continue holding the ON / OFF button and slowly slide the unit across the wall. Keep the unit base in contact with the wall. The "AC" indicator will appear on the LCD if a hot wire is nearby. All bars indicates the closest proximity. Mark this point.

CAUTION

The unit will not detect live wires inside metal pipe or metal conduit, behind metallic wall coverings, or behind some plywood or other dense materials. Use extra caution in these construction situations. Always turn the power off when nailing, cutting or drilling near electrical wiring.

5

CAUTION

The unit will not detect items that are shielded in some way or are in excess of 38mm from the surface.

AUTOMATIC SCAN MODE

When the unit is in Auto Scan mode, it will search for studs, metal and livewire simultaneously. The LCD display will indicate which material has been detected.

1. Select "AUTO" mode.
2. Position the sensor flat against the wall. Press and hold ON / OFF button.
3. Slowly slide the unit horizontally across the wall, to the left or right. Keep the unit base in contact with the wall. If more than one object is detected, they will each be indicated. The material with the strongest signal will display, and the other icons will flash.

6

Maintenance and Repairs

- Remove batteries from the unit during lengthy periods of non-use, and store in a clean dry place.
- Do not take the unit apart or permit any unqualified person to take the unit apart. Unauthorized servicing may irreparably damage the unit, and invalidate the warranty.

Warranty

This product is covered by a two-year limited warranty against defects in materials and workmanship. It does not cover products that are used improperly, altered, or repaired.

In the event of a problem with the unit you have purchased, please return the product to the place of purchase with proof of purchase.

© Kapro Industries Ltd.

7